

ARTIC FIBER manufacturer from China is a leading global supplier of fiber optical components and systems for connectivity solution. Our customers in communication, industry and transportation appreciate that we are specialists with detailed knowledge of practical applications.

DATASHEET

10 Ports FTTX Indoor Fiber Optical Distribution Terminal Box

- For FTTx Solution



ART-ABT-10P
ART-ABT-10P-90/10
ART-ABT-10P-80/20
ART-ABT-10P-70/30
ART-ABT-10P-60/40
ART-ABT-10P-50/50

Product Description

This kind of 10 ports mini Fiber Distribution terminal Box is used as a termination point for the feeder cable to connect with drop cable in FTTx communication network system. The fiber splicing, splitting, and distribution can be done in this box, and meanwhile it provides solid protection and management for the FTTx network building.

Standards Comply

The production offered by ARTIC are designed, manufactured and tested according to the standards as follows:

IEC 62134-1	Fiber optic enclosures - Part 1: Generic specification
IEC61300-2	Fiber optic interconnecting devices and passive components - Basic test and measurement procedures
IEC60068-2	Basic environmental testing procedures for electric and electronic products

Applications Environment

Item	Value
Operation temperature	-40 °C~+65 °C
Installation temperature	-15 °C~+40 °C
Storage temperature	-45 °C~+75 °C
Relative humidity	≤85% (+30°C)
Atmospheric pressure	70KPa~106Kpa

Keyed Characteristics

- ✓ Advanced structure design, Small size and reasonable structure.
- ✓ Material: PC+ABS.
- ✓ Dust-proof, anti-aging.
- ✓ Protection level up to IP20.
- ✓ The interior is equipped with 1x2 FTB splitter, 1x8 PLC splitter.
- ✓ Installation method: wall-mounted.

Application

- ✓ CATV;
- ✓ Telecommunication networks;
- ✓ Wide Area Networks;
- ✓ Industrial, medical & military;
- ✓ Local Area Networks;

Mechanical Specifications

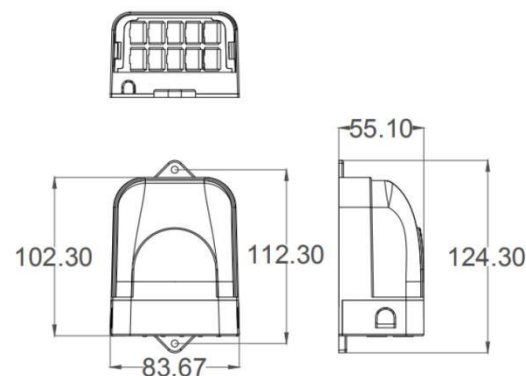

Item	Specification	Notes
Material of housing	PC+ABS	
Material of metal accessory	High-quality stainless steel	
External dimension (mm)	102x84x55mm	
Color	White	
Number of adaptor (Max)	10P	
Splitter	1x2 FTB splitter + 1x8 PLC splitter	Default ratio of 1x2 FBT splitter is 70%/30%
IP grade	IP20	
Flammability	UL94-HB	Default
Neutral salt spray test (NSS)	48h	

Port Color

● Red | ● Blue | ● Green

Routing Diagram

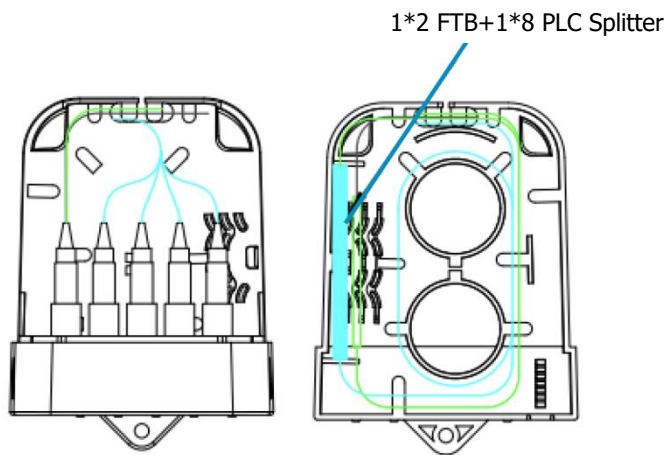

Configuration

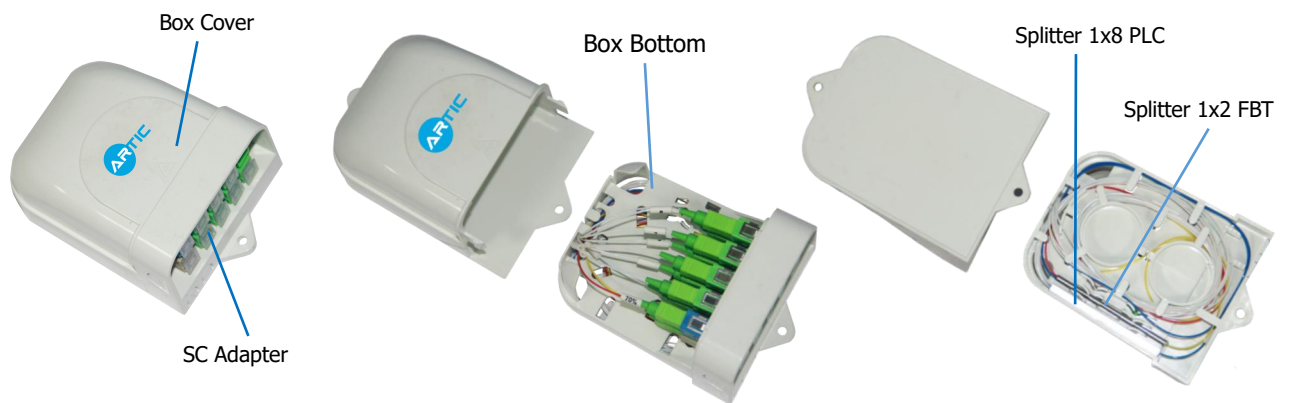

Accessories

No.	Part name	Reference picture	Unit	Quantity	Remark
1	Users' manual	/	PCS	1	EN
2	Splitter test report	/	PCS	1	EN
3	Wall-mounted kit		Sets	1	Optional as customer's request

Wall-mounted Installation

Drill 2 holes in the wall according to the dimension in table 2, place the expansion plug $\Phi 8 \times 40$, place the box to match up the holes and use screws to fasten.

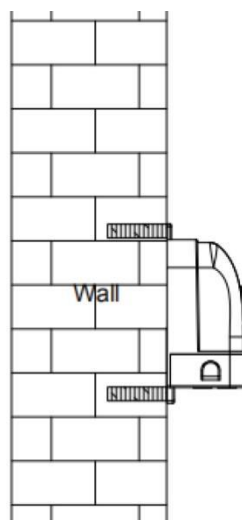

Wallmounted installation

Optical Specifications

Model	Splitter	IL (dB)		RL (dB)	IL (dB)	Test method
		Splitter			Distribution box	
ARABT10P	1*2 FBT (90/10) + 1*8 PLC Splitter, with SCAPC connector	1*2 FBT (90%)	≤0.83	≥55	≤1.03	IL: IEC61300-3-4 Method B RL: IEC61300-3-6 Method 1
		1*2 FBT (10%) + 1*8 PLC	≤21.7	≥55	≤21.9	
	1*2 FBT (80/20) + 1*8 PLC Splitter, with SCAPC connector	1*2 FBT (80%)	≤1.4	≥55	≤1.6	
		1*2 FBT (20%) + 1*8 PLC	≤18.3	≥55	≤18.5	
	1*2 FBT (70/30) + 1*8 PLC Splitter, with SCAPC connector	1*2 FBT (70%)	≤2.1	≥55	≤2.3	
		1*2 FBT (30%) + 1*8 PLC	≤16.5	≥55	≤16.7	
	1*2 FBT (60/40) + 1*8 PLC Splitter, with SCAPC connector	1*2 FBT (60%)	≤2.8	≥55	≤3	
		1*2 FBT (40%) + 1*8 PLC	≤15.2	≥55	≤15.4	
	1*2 FBT (50/50) + 1*8 PLC Splitter, with SCAPC connector	1*2 FBT (50%) + 1*8 PLC	≤3.8	≥55	≤4	
	1*8 PLC Splitter, with SCAPC connector	1*8 PLC	≤10.5	≥55dB	≤10.7	

The optical parameters shown in the table above are default values, and can be customized according to requirements.

Packing Information

Item	Material	Size (mm)	Quantity	Gross Weight (kg)
Independent product packaging	Carton	130 x 90 x 60	1	0.2
Outer packaging carton	Carton	380 x 280 x 330	40	9